

PL # 5308

ZONING COMMISSION
Town of New Fairfield
4 Brush Hill Rd.
New Fairfield, CT 06812
203-312-5646 Fax 203-312-3508

SITE PLAN APPLICATION

Application Number JI-22-024

Map: 24 Block: 19 Lot: 1

Please type or print:

Date: 8-5-22

Applicant: Mario Rodriguez

Mailing Address: 36 Ave D Norwalk CT

Project Address: 96 Route 37 New Fairfield CT

Phone No: 203-722-3179

Owner (s) of Record: Christopher Santomero

Address: 96 Route 37

Phone No: 914 448 8300

Application is hereby made for site plan per section 8.1 and pursuant to the following section (s) of the Zoning Regulations:

Business/Commercial - Section 4.1.1(P)

For the following purpose: Boat Canvas

In compliance with the requirements of the Zoning Regulations, I am hereby submitting the fee, plans, documents and additional information as required.

Fee of \$160.00 (Includes State Surcharge).

Application Requirements:
(see attached)

received
08-18-22

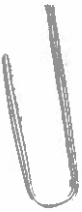

Report from Health Department on adequacy of sewage disposal system and water supply.

Report (s) from other Town Agencies as follows:

- Fire Marshal
- Town Engineer
- Inland Wetland Commission
- Conn. Dept. of Transportation
- Zoning Enforcement Officer
- Other Agency (please specify) _____
- Copy of additional information as follows: _____

~~_____~~
Signature of owner (date)

M. Mac
Signature of Applicant (date)

For Office Use Only

This Application Complies Does Not Comply with the requirements of the zoning regulations.

Application Complete: _____ Yes _____ No

The application fails to comply as follows: _____

Comments: _____

Review by Zoning Enforcement Officer _____ Date _____

Date of Receipt by Zoning Commission: _____

Date of Commission Action: _____ Legal Notice Published _____

Application Approved Application Denied

Application Approved & Modified

Conditions: _____

Floor Plan (1250 Sq Feet)

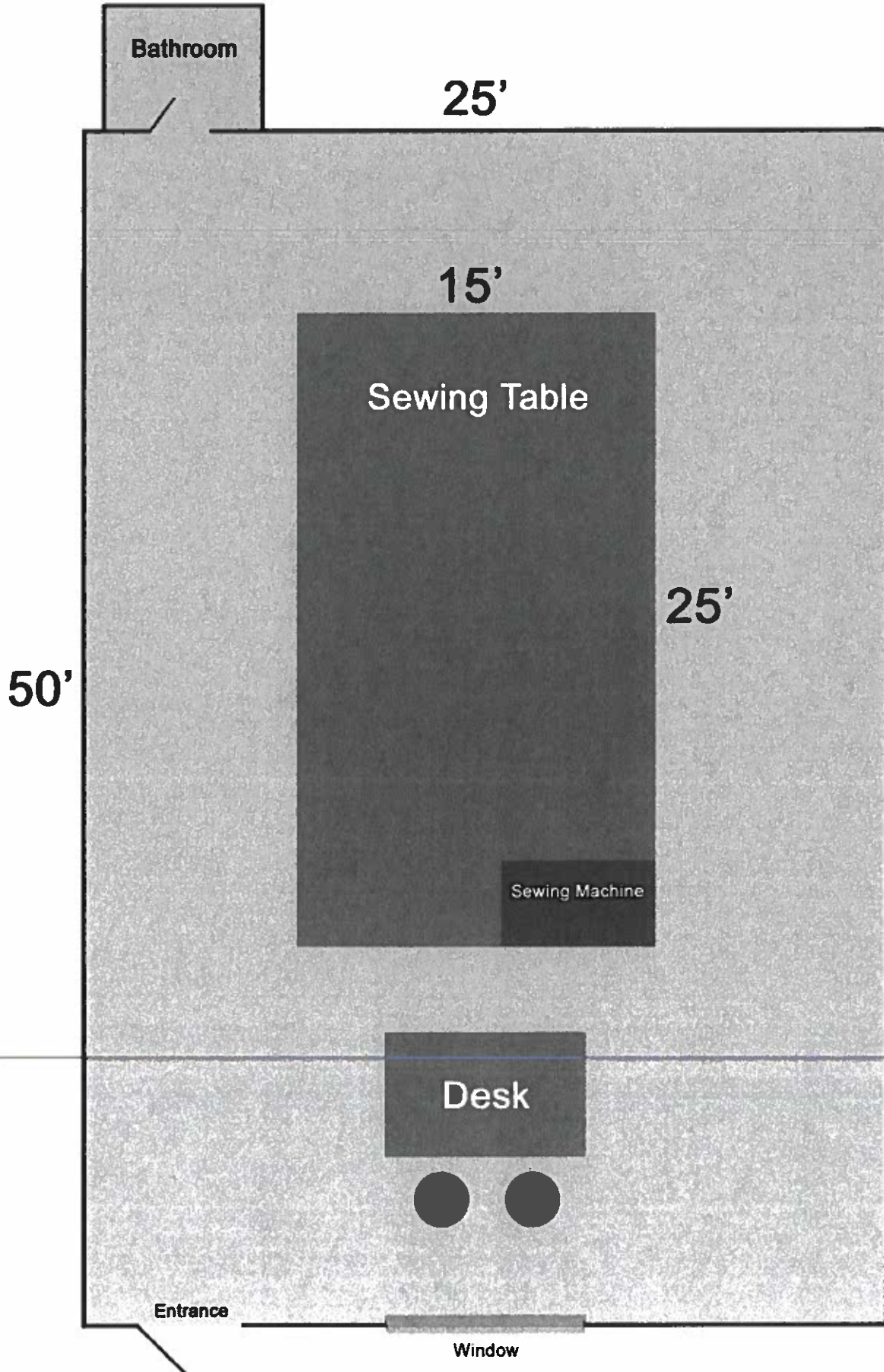

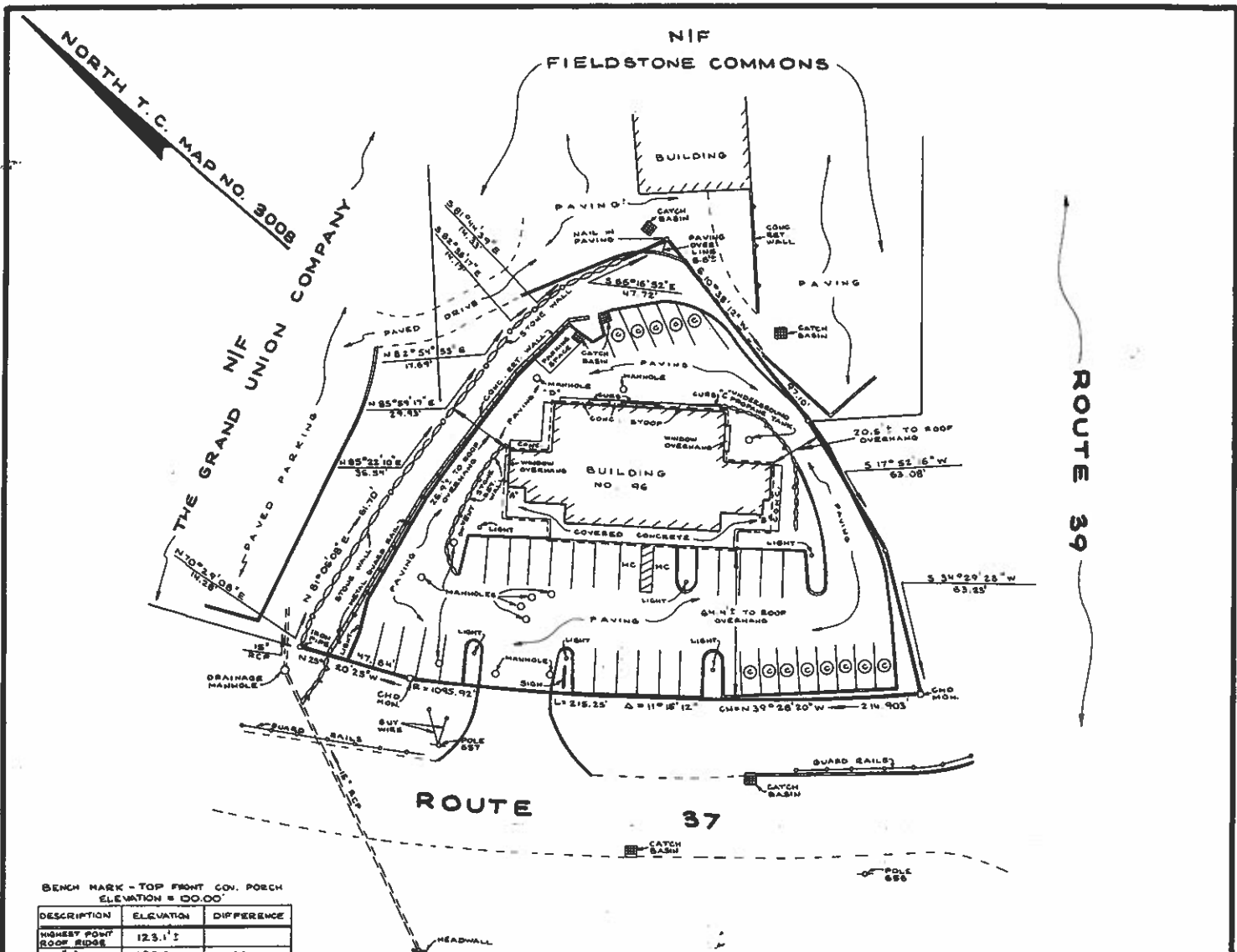

BENCH MARK - TOP FRONT CON. PORCH
ELEVATION = 00.00'

DESCRIPTION	ELEVATION	DIFFERENCE
HIGHEST POINT ROOF RIDGE	123.1'	
"A"	100.0	23.1
"B"	100.0	23.1
"C"	92.7	30.4
"D"	89.3	33.8
AVERAGE GRADE DIFFERENCE = 27.6'		

PROPERTY SURVEY

PREPARED FOR

ALPINE REALTY, LLC

AND

WESCON DEVELOPMENT COMPANY

96 ROUTE 37

TOWN OF NEW FAIRFIELD, FAIRFIELD COUNTY, CT.

FILE COPY

NOV. 11, 1999

SCALE 1" = 30'

AREA = 31,335 SQ. FT.
0.7194 ACRES

CERTIFIED TO:
1) TOWN OF NEW FAIRFIELD *Final A-2*

NOTES:

- 1) REFERENCE MADE TO TOWN CLERK MAP NO. 1541, 1559, 2705 & 3008 OF THE NEW FAIRFIELD LAND RECORDS.
- 2) REFERENCE MADE TO STATE OF CONNECTICUT HIGHWAY RIGHT OF WAY MAPS.
- 3) THIS SURVEY MAP IS A DEPENDANT RESURVEY OF PARCEL AS DEPICTED ON T.C. MAP NO. 3008

THIS SURVEY MAP HAS BEEN PREPARED IN ACCORDANCE WITH SECTIONS 20-300 B-1 THRU 20-300 D-20 OF THE REGULATIONS OF CONNECTICUT STATE AGENCIES - MINIMUM STANDARDS FOR SURVEYS AND MAPS IN THE STATE OF CONNECTICUT EFFECTIVE 06-21-96 AS ENDORSED BY THE CONNECTICUT ASSOCIATION OF LAND SURVEYORS, INC. IT IS A PROPERTY SURVEY BASED ON A RESURVEY OF EXISTING MAPS.

THIS SURVEY CONFORMS TO CLASS A-2 MAP. TO THE BEST OF MY KNOWLEDGE AND BELIEF THIS MAP IS SUBSTANTIALLY CORRECT AS NOTED HEREON.

PREPARED BY THE OFFICE OF
PAUL A. HIRO, P.C.

35 DANBURY ROAD
NEW MILFORD, CT.
Paul A. Hiro
CONN. REG. NO. 15167