

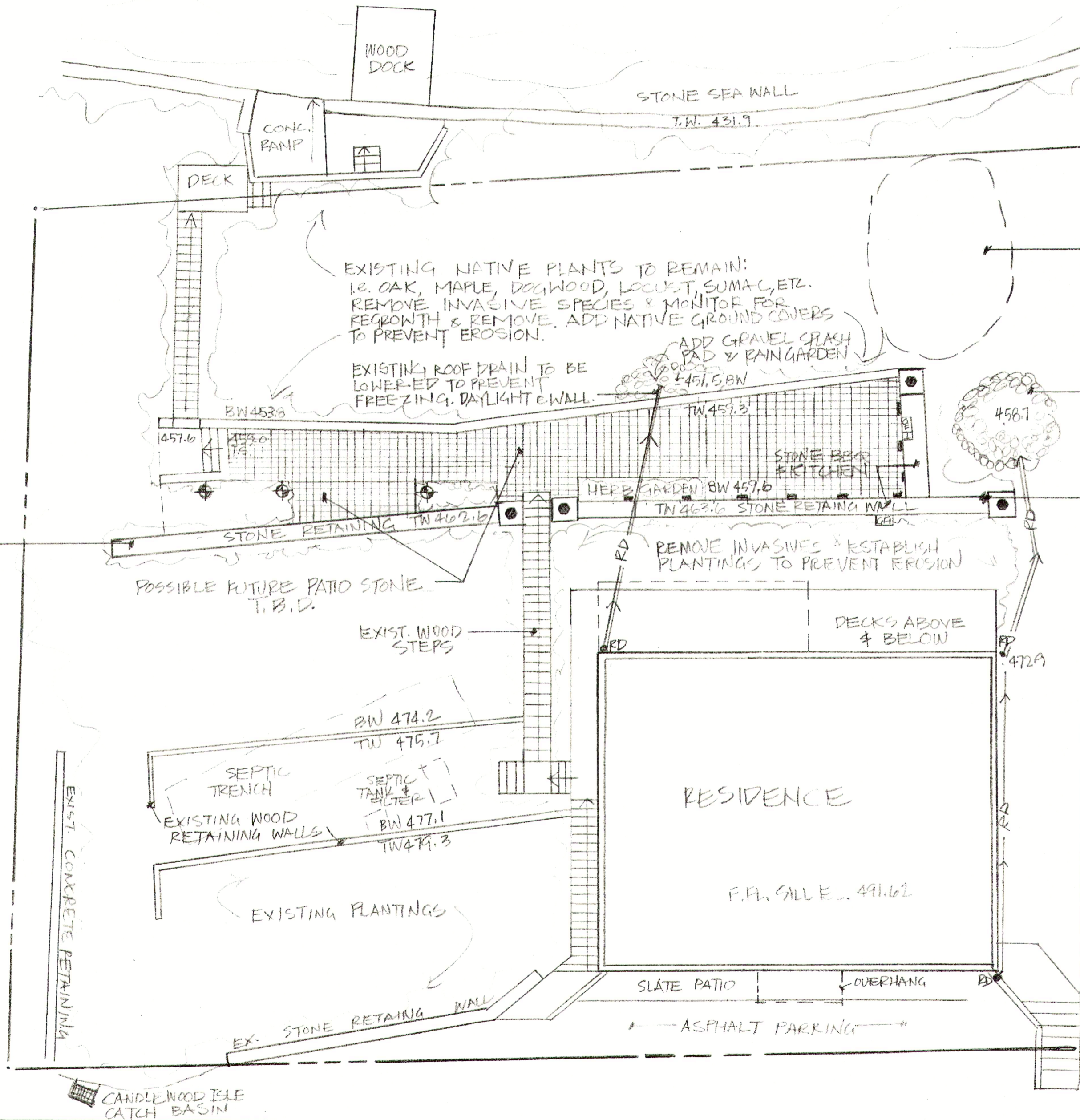

CANDLEWOOD LAKE



LIGHTING KEY

- WALL INSET FIXTURE
- GFI OUTLET
- PILLAR MOUNTED FIXTURE
- FUTURE PATH LIGHT
- POST LAMP

ADD NATIVE GROUND COVER PLANTINGS TO STABILIZE FILL. NO GRASS WILL BE MAINTAINED IN FUTURE.

PROPOSED RAIN GARDEN. EXTEND ROOF DRAIN (RD) PIPES AS SHOWN DAYLIGHT IN GRAVEL BASIN & INSTALL NATIVE PLANTS TO FACILITATE ABSORPTION.

NEW STONE RETAINING WALL @ 4' MAX. HEIGHT W/ REINFORCING & WEEP HOLES & LIGHTING.

NEW STONE RETAINING WALL TO REPLACE EXISTING WOOD STRUCTURE.

EXISTING NATIVE PLANTS TO REMAIN: I.E. OAK, MAPLE, DOGWOOD, LOCUST, SUMAC, ETC. REMOVE INVASIVE SPECIES & MONITOR FOR REGROWTH & REMOVE. ADD NATIVE GROUND COVERS TO PREVENT EROSION.

EXISTING ROOF DRAIN TO BE LOWERED TO PREVENT FREEZING. DAYLIGHT @ WALL.

REMOVE INVASIVES & REESTABLISH PLANTINGS TO PREVENT EROSION

NOTES:

1. DRAWING IS BASED ON 'PLOT PLAN/PROPERTY SURVEY' PREPARED FOR YAKOV & ANNA KRAYN BY GEOLOGIC LAND SURVEYING, PLLC. UPDATED 07/26/2021.
2. FIELD NOTES ON VEGETATION BY HINES & ASSOCIATES, MAY 2021.
3. ALL UTILITIES SHALL BE MARKED IN FIELD PRIOR TO ANY WORK COMMENCING. CALLBEFOREUDIG
4. ALL STORM WATER MANAGEMENT & SEPTIC SYSTEM LOCATIONS SHALL BE MARKED IN FIELD PRIOR TO ANY WORK COMMENCING.
5. ALL WORK TO BE DONE IN ACCORDANCE WITH TOWN OF NEW FAIRFIELD & STATE OF CONNECTICUT, BUILDING CODES AND REGULATIONS.
6. NO WORK BELOW THE 440 LINE WILL BE DONE WITHOUT PERMIT FROM FIRST LIGHT POWER CO.
7. EROSION CONTROLS SHALL BE INSTALLED AND MAINTAINED THRU PROJECT UNTIL ALL SOILS ARE STABLE.

plan @ new stone retaining walls

residence of

yakov & anna krayn

16 LAKE DRIVE SOUTH
 CANDLEWOOD ISLE
 New Fairfield, Connecticut

Scale: 1" = 10'

Page 1 of 1

date: 7/27/2021

by: e. p. hines

HINES & ASSOCIATES LANDSCAPE ARCHITECTURE

115 Plumtrees Road • Bethel, Connecticut 06801 • 203-744-1478

LAKE DRIVE SOUTH

