

TABLE	DATE
X X	8/11/17
X X	
X X	

**APPROVED PLAN**  
 Date: 8/11/17  
 Signature: [Signature]

**PROPOSED PLAN - B-100**



ERIN DRIVE

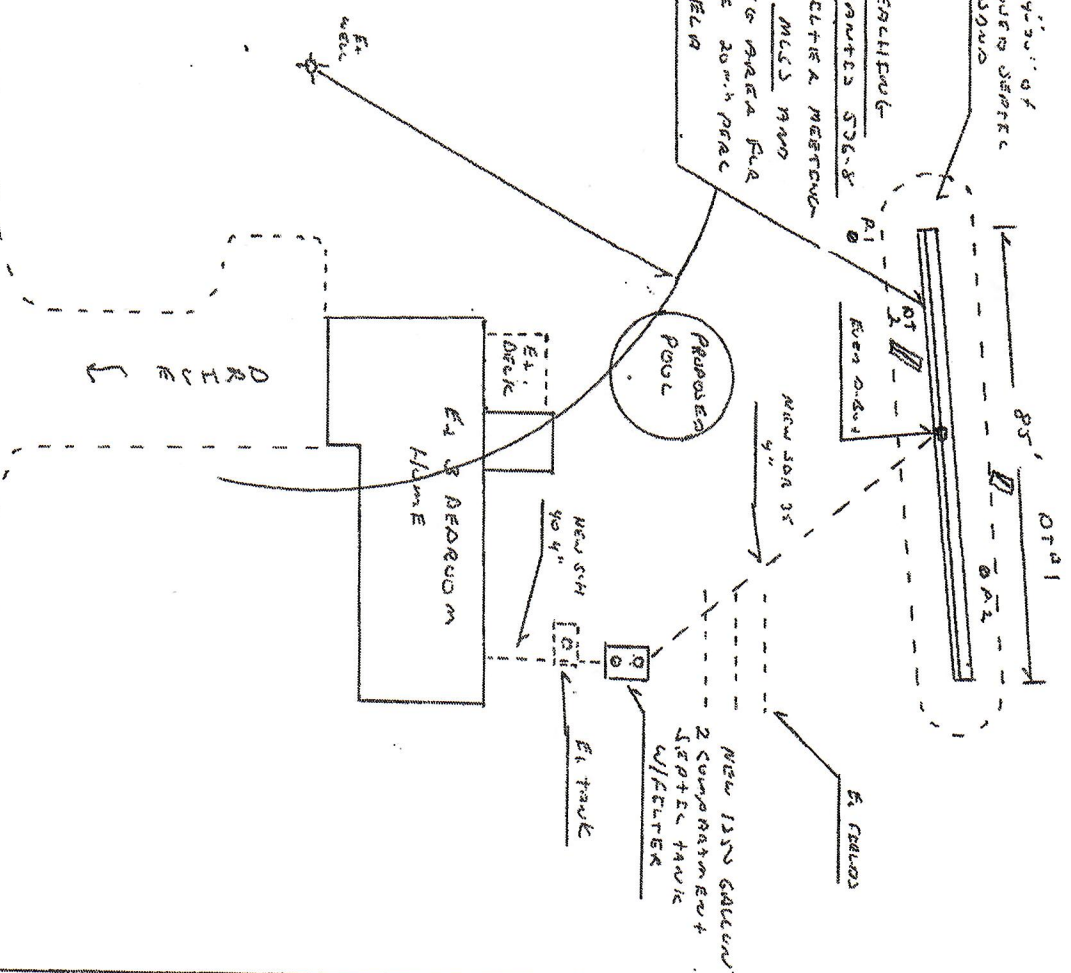

DEEP #1	DEEP #2	P-1
0-6 10' deep	0-2 10' deep	0 3 3/4
6-32 6" x 8" RIS	7-22 6" x 8" RIS	1 6 1/4
32-71 6" x 8" RIS	22-34 6" x 8" RIS	2 7 1/4
no cover	no cover	30 - ON FLOOR
no LID	no LID	60 - HORIZONTAL
REST 32"	REST 32"	60 - HORIZONTAL
NO G 27"	NO G 27"	1' 20" DIA

**B-100-A**  
 FOR PROPOSED POOL AND POSSIBLE 4th BEDROOM

- 1) NEW 135 GALLON 2 COMPARTMENT SEPTIC TANK WITH OILLET FILTER
  - 2) STAFF PASSAGE IN APPROVED SEPTIC AREA AND REMOVE WITH 24" DIA.
  - 3) INSTALL 65' OF MANHOLE 32" x 48" NEW 135 GALLON 2 COMPARTMENT SEPTIC SYSTEM MEETING 100% OF REGULATED MILES AND 65' x 110' = 935 SF AREA
  - 4) APPROVE POOL CONSTRUCTION GRASS SEED MAY ALL ORIGINATED AREAS
  - 5) RECONNECT AND ADJUST TO NEW ASSAULT MANHOLE
- \* THIS IS ONE OF MANY POSSIBLE SEPTIC SYSTEM REG THIS SETTING  
 \* ALL WELLS WITH IN 25'

T. Palmer Septic & Excavation  
 P.O. Box 8196  
 New Fairfield, CT 06812  
 (203) 746-3637  
 CT # 5176

**DICHIARAUO**  
 # 14 ERIN DRIVE  
 NEW FAIRFIELD  
 WTS 8-10-17