

FIGURE R603.3.1(4)
WIND UPLIFT CONNECTOR

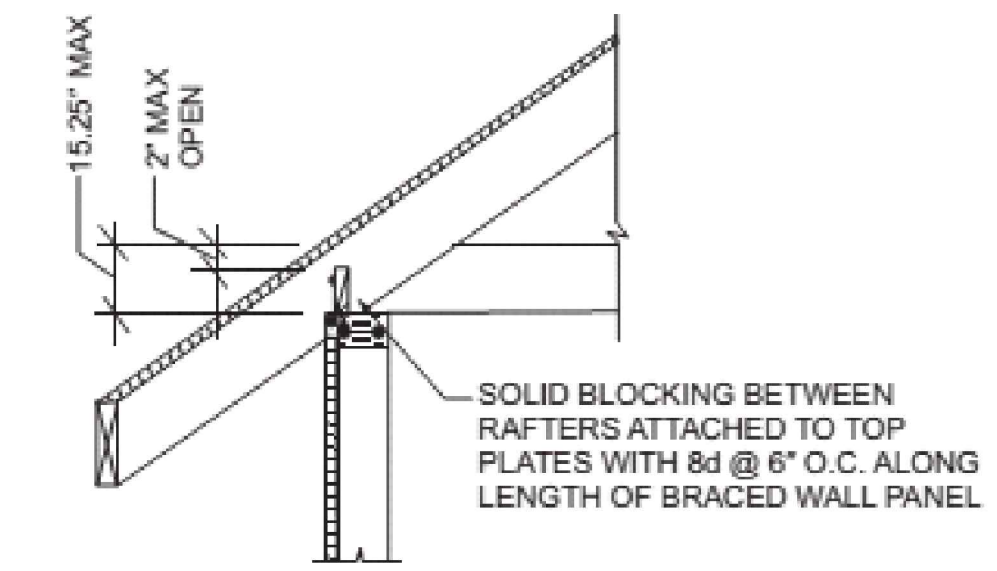

FIGURE R602.10.8.2(1)
BRACED WALL PANEL CONNECTION TO PERPENDICULAR RAFTERS

TABLE R301.2.1.2 WINDBORNE DEBRIS PROTECTION FASTENING SCHEDULE FOR WOOD STRUCTURAL PANELS a, b, c, d			
FASTENER SPACING (inches) a, b			
FASTENER TYPE	Panel span < 4'	4' < PANEL panel span < 6 feet	6' < PANEL SPAN, 8'
No. 8 wood screw based anchor with 2-inch embedment length	16	10	8
No. 10 wood screw based anchor with 2" embedment length	16	12	9
1/4-inch lag screw based anchor with 2" embedment length	16	16	16

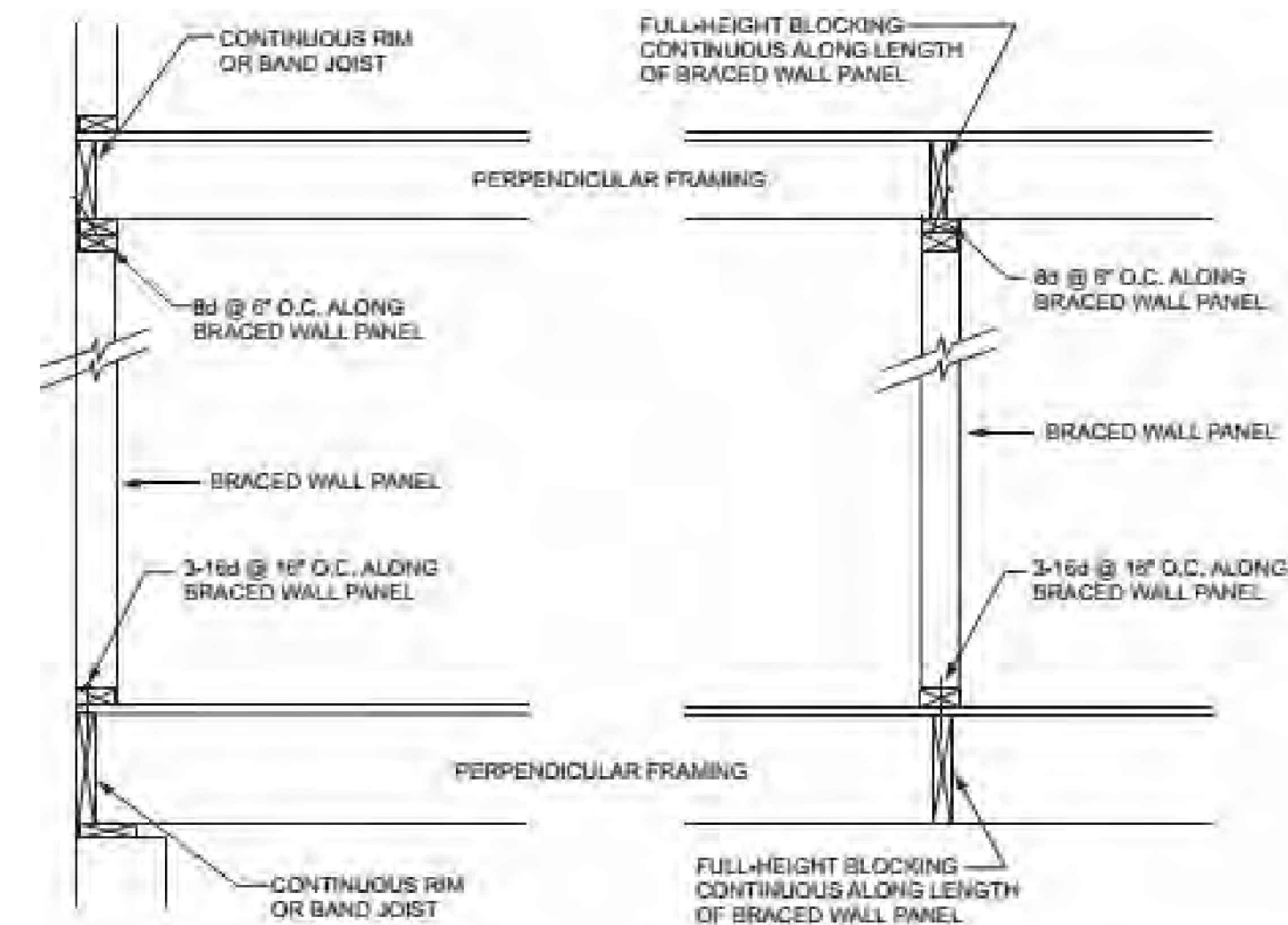

FIGURE R602.10.8(1)
BRACED WALL PANEL CONNECTION WHEN PERPENDICULAR TO FLOOR/CEILING FRAMING

TABLE R602.3(1) FASTENING SCHEDULE			
ROOF			
ITEM	DESCRIPTION OF BUILDING ELEMENTS	NUMBER AND TYPE OF FASTENER a, b, c	SPACING AND LOCATION
1	Blocking between ceiling joists or rafters to top plate	4-8d box (2 1/2" x 0.131) or 3-8d common (2 1/2" x 0.131), or 3-10d box (3" x 0.128), or 3-3" x 0.131 nails	TOE NAIL
2	Ceiling joists to top plate	4-8d box (2 1/2" x 0.131), or 3-8d common (2 1/2" x 0.131), or 3-10d box (3" x 0.128), or 3-3" x 0.131 nails	Per joist, toe nail
3 & 4	CEILING JOISTS NOT ATTACHED AND ATTACHED PARALLEL RAFTERS; Table R602.5.1(1) AND R602.5.2		
5	Collar tie to rafter, face nail or 1/4"	4-10d box (3" x 0.128), or 3-10d common (3" x 0.148), or	Face nail each rafter
TABLE R603.3.2(1) WALL FASTENING SCHEDULES			
DESCRIPTION OF BUILDING ELEMENT	NUMBER AND SIZE OF FASTENERS	SPACINGS OF FASTENERS	
Wall stud to top or bottom track	2-No. 8 screws	Each end of stud, one per flange	
Structural sheathing to wall studs	No. 8 screws b	6" o.c. on edges and 12" o.c. at intermediate supports	
1/2" gypsum board to framing for 5/8" 1 inch x 25/4 min.	No. 6 screws	12" o.c.	

a. All screw sizes shown are minimum.
b. Screws for attachment of structural sheathing panels are to be bugle-head, flat-head, or similar head styles with a minimum head diameter of 0.24 inch.

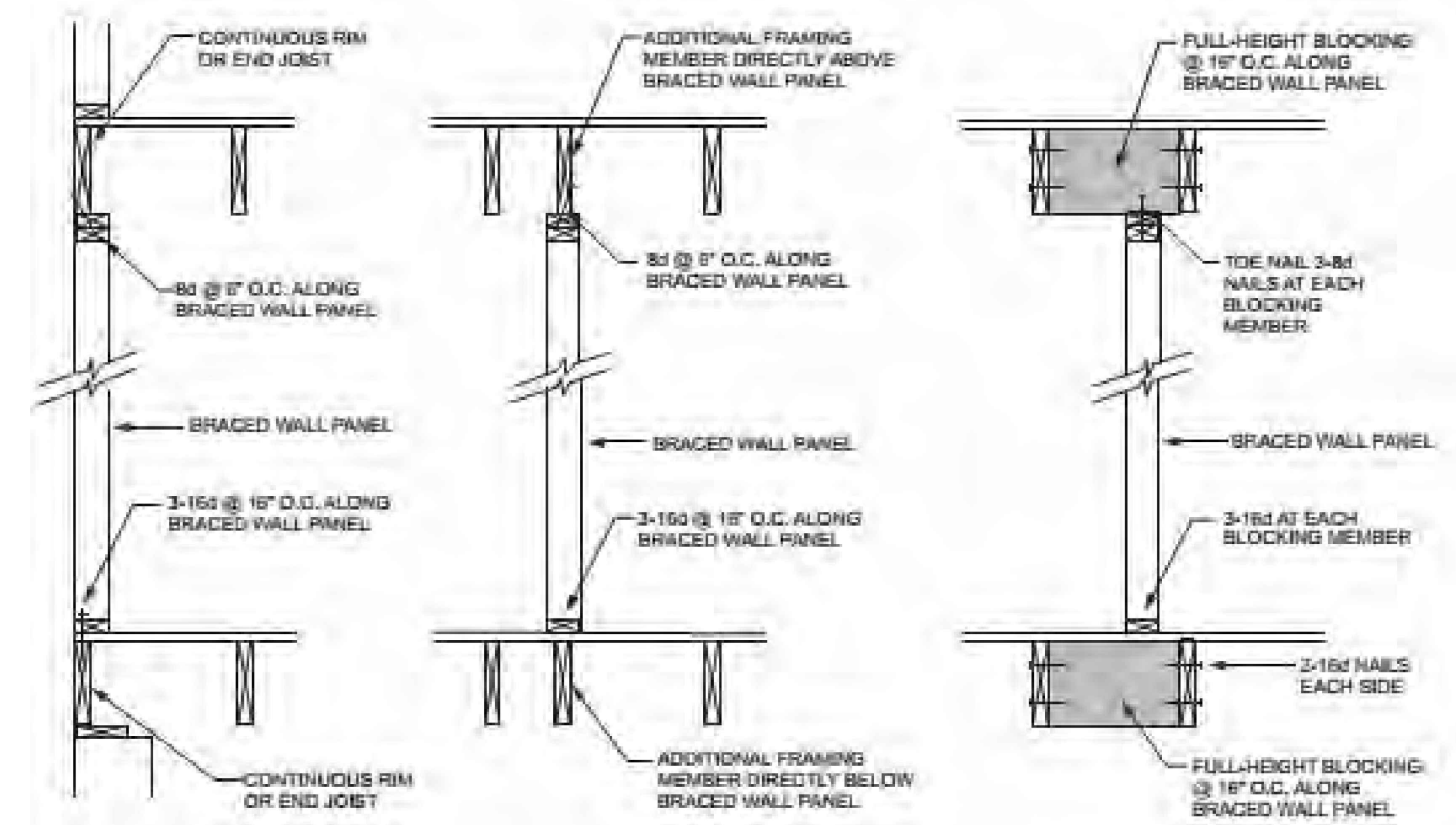

FIGURE R602.10.8(2)
BRACED WALL PANEL CONNECTION WHEN PARALLEL TO FLOOR/CEILING FRAMING

