

POSSIBLE UNKNOWN UNDERGROUND UTILITIES LOCATED WITHIN SURVEYED AREA SHOWN HEREON

EXISTING INFORMATION TABLE	
	CATCH BASIN
	UTILITY POLE
	FIRE HYDRANT
	STORM MANHOLE
	SANITARY SEWER MANHOLE
	UTILITY BOX (SIZE & USE VARIES)
	OVERHEAD SERVICE WIRES
	EDGE OF PAVEMENT
	CURBING (TYPE VARIES)
	WATER OR GAS VALVE
	LIGHT POLE
	FENCE (TYPE VARIES)

VERTICAL INFORMATION TABLE	
455.9	SPOT SHOT ELEVATION
---622---	CONTOUR LINE
---620---	CONTOUR LINE

BRUSH HILL ROAD

CONN. ROUTE 39

NEW FAIRFIELD CEMETERY ASSOCIATION

NOW OR FORMERLY
CITY OF DANBURY
VOL.13 PG.400 - OF THE N.F.L.R.

NOW OR FORMERLY
CITY OF DANBURY
MARJORIE RESERVOIR

OWNERSHIP NOTES:

- OWNERS OF RECORD: **ECB REALTY, LLC** - VOL.488 PG.1034-1036 OF THE D.L.R.

SURVEY NOTES:

- THIS SURVEY AND MAP HAS BEEN PREPARED PURSUANT TO THE REGULATIONS OF CONNECTICUT STATE AGENCIES SECTIONS 20-3006-1 THROUGH 20-3006-20 AND THE "STANDARDS FOR SURVEYS AND MAPS IN THE STATE OF CONNECTICUT" AS ADOPTED BY THE CONNECTICUT ASSOCIATION OF LAND SURVEYORS, INC. ON SEPTEMBER 26, 1996. IT IS AN TOPOGRAPHIC SURVEY BASED ON A V-2 AND TOPOGRAPHICAL ACCURACY T-2.
- MONUMENTATION FOUND OR SET DEPICTED HEREON.
- ELEVATIONS SHOWN REFER TO NATIONAL GEODETIC VERTICAL DATUM OF 1929.
- UNDERGROUND UTILITIES SHOWN ARE APPROXIMATE. LOCATIONS ESTABLISHED FROM EXISTING PLANS AND MAPS. FIELD LOCATION OF EXISTING STRUCTURES, AND UTILITY MARKINGS IF ANY. NO WARRANTY NOR GUARANTEE OF UTILITY LOCATIONS MADE. ADDITIONAL UTILITIES MAY EXIST.
- SUBJECT TO NOTES, EASEMENTS, RIGHTS OF WAY, CONDITIONS, FACTS AND ALL MATTERS SET FORTH ON MAP NO.3220 OF THE NEW FAIRFIELD LAND RECORDS.
- SUBJECT TO PASSWAY RIGHTS AND EASEMENTS RECORDED IN VOL.13 PG.392 OF THE NEW FAIRFIELD LAND RECORDS SAID INSTRUMENT IS IS AFFECTED BY A RELEASE OF EASEMENT RECORDED IN VOL.194 PG.758 OF THE N.F.L.R.
- SUBJECT TO RESERVATIONS AND RIGHTS AS RECORDED IN VOL.23 PG.46 OF THE NEW FAIRFIELD LAND RECORDS.
- SUBJECT TO EASEMENTS TO THE CITY OF DANBURY RECORDED IN VOL.195 PG.709 OF THE NEW FAIRFIELD LAND RECORDS.
EASEMENT "A" - 30' ACCESS EASEMENT
EASEMENT "B" - 30' DRAINAGE EASEMENT
EASEMENT "D" - 30' DRAINAGE EASEMENT (LOCATION OF EASEMENT TAKEN FROM MAP NO.3220 OF THE N.F.L.R.)

SURVEY NOTES CONTINUED:

- SUBJECT TO NOTICE BY THE NEW FAIRFIELD BOARD OF APPEALS RECORDED IN VOL.172 PG.968 OF THE NEW FAIRFIELD LAND RECORDS.
- SUBJECT TO LEASE TO THE UNITED STATES OF AMERICA RECORDED 1 NVOL.52 PG.55 AND EXTENSION RECORDED IN VOL.136 PG.452 OF THE NEW FAIRFIELD LAND RECORDS.
- SUBJECT TO SHORT FORM LEASE TO THE UNITED STATES POSTAL SERVICE RECORDED IN VOL.153 PG.364 OF THE NEW FAIRFIELD LAND RECORDS.
- SUBJECT TO A MEMORANDUM OF LEASE TO THE UNITED STATES POSTAL SERVICE RECORDED IN VOL.242 PG.639 OF THE NEW FAIRFIELD LAND RECORDS.
- SUBJECT TO CERTIFICATE OF NOTICE RECORDED IN VOL.352 PG.979 OF THE NEW FAIRFIELD LAND RECORDS.
- REFER TO MAP 3220 OF THE NEW FAIRFIELD LAND RECORDS.
- REFER TO PLAN ENTITLED CITY OF DANBURY, CONNECTICUT, REPAIRS AND MODIFICATIONS TO RESERVOIR DAMS CONTRACT NO.7, MARGERIE LAKE RESERVOIR DIKE, SHEETS 1 THROUGH 5 DATED JANUARY 1994. COD WATER NO.418 PROPERTY LOCATED IN ZONE X (UNSHADED) REFER TO NATIONAL FLOOD INSURANCE RATE MAP FAIRFIELD COUNTY, CONNECTICUT (ALL JURISDICTIONS), PANEL 128 OF 626 MAP NO. 090010128P, EFFECTIVE DATE JUNE 18, 2010.
- PROPERTY LINES SHOWN HEREON ESTABLISHED FROM MAP NO.3220 OF THE NEW FAIRFIELD LAND RECORDS.
- REFER TO RELEASE OF EASEMENT RECORDED IN VOL.194 PG.758 OF THE NEW FAIRFIELD LAND RECORDS.

IMPORTANT
LOCATION OF UNDERGROUND UTILITIES SHOWN HEREON ARE APPROXIMATE. NO WARRANTY NOR GUARANTEE OF LOCATION MADE. PRIOR TO ANY CONSTRUCTION OR EXCAVATION WORK "CALL BEFORE YOU DIG" (800)922-4455

TOPOGRAPHIC SURVEY

PREPARED FOR
ECB REALTY, LLC
SHOWING PROPERTY SITUATED AT
7-9 BRUSH HILL ROAD ~ CONN. RT 39
NEW FAIRFIELD, CONNECTICUT
TAX ASSESSOR MAP 28 ~ BLOCK 8 ~ LOT 10 & 11

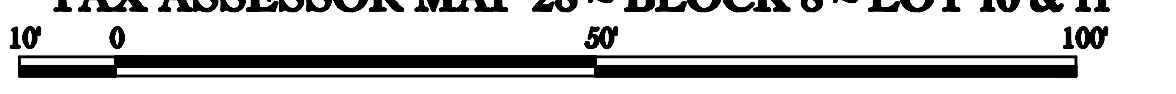

SCALE: 1"=20'	ZONE: C
AREA: 35,998 Sq. Ft.	DATE: AUG. 23, 2013
DRAWN BY: Z.S.R.	DRAWING NAME: 13098_TOPO
Sydney A. Rapp Land Surveying, P.C. 159 Greenwood Avenue, Bethel, Connecticut 06801 80 Lindemont Drive, Danbury, Connecticut 06811 maps@rapplandsurveying.com • Phone (203)744-6261	